

**kit:** bacino (PST) / basin (PST) / pila (PST) - piletta sifonata (35lt/min) / siphon waste (35lt/min) / válvula de desagüe con sifón (35lt/min) - rete di ancoraggio / anchoring mesh / red de fijación - imbuto regolabile con griglia / adjustable funnel with grille / embudo regulable con rejilla

**opt:** alzata e pedana composite in corian / riser and footboard in corian / zócalo y tarima compuestos de corian

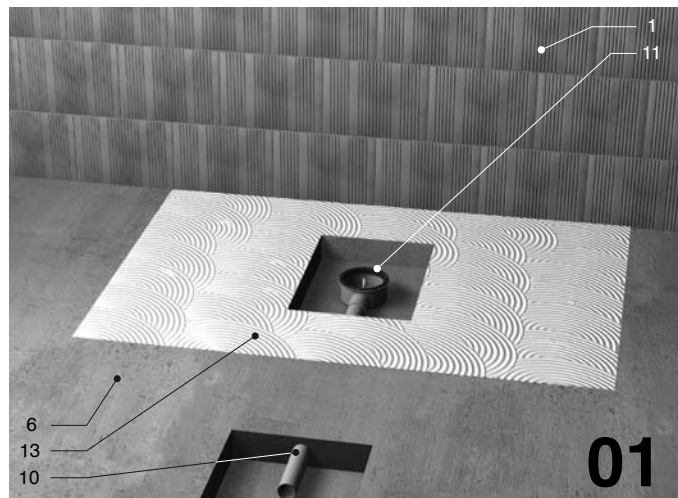

01

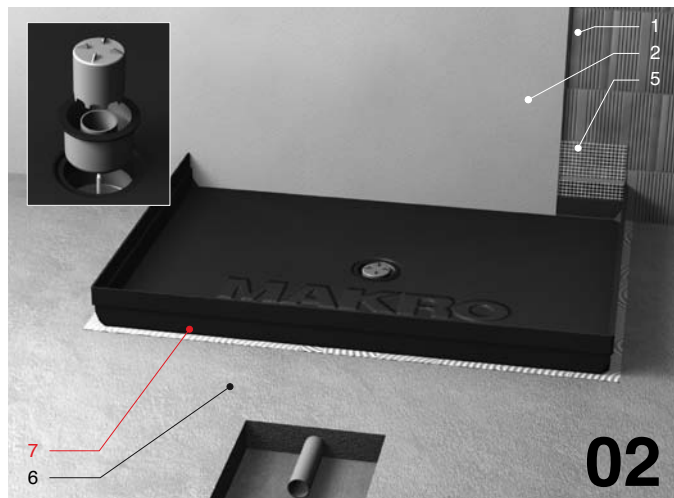

02

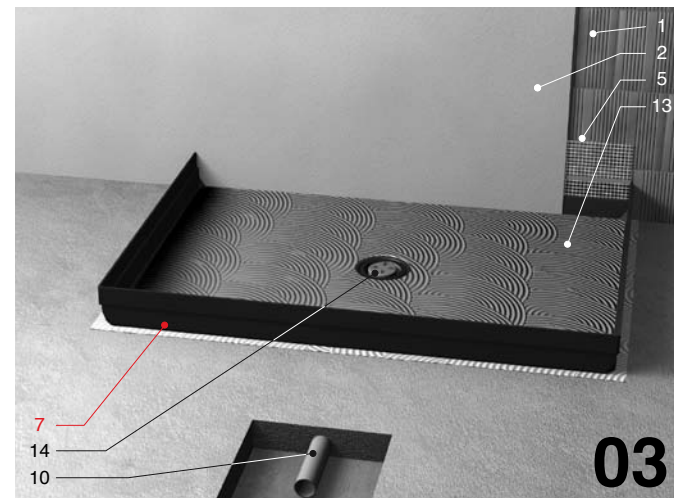

03

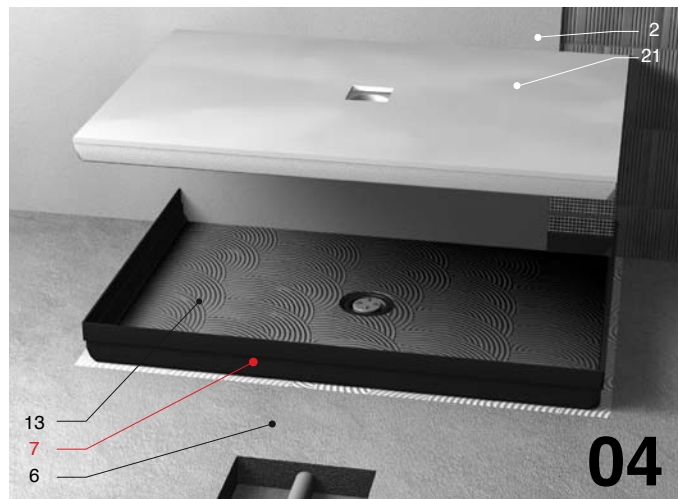

04

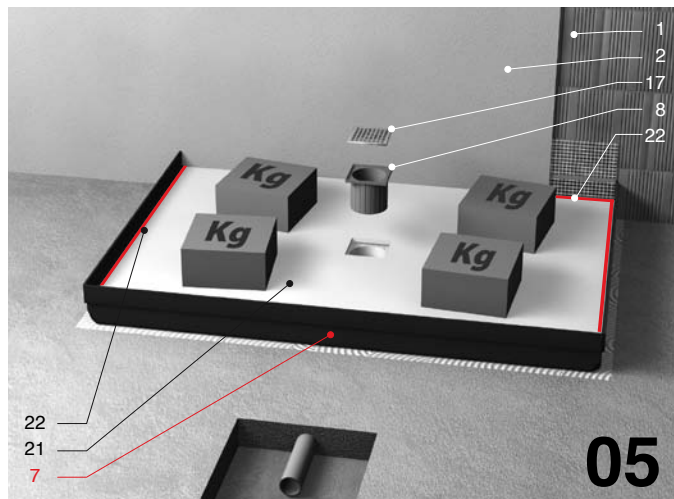

05

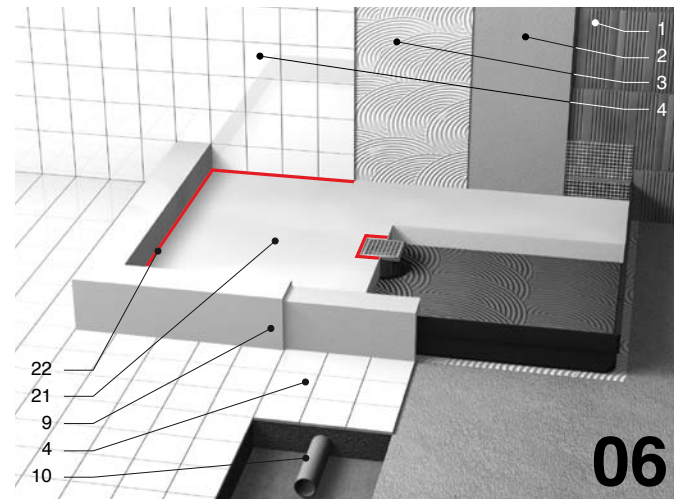

06

1\_ muratura / masonry / mampostería

2\_ intonaco / mortar / enlucido

3\_ colla / glue / cola

4\_ rivestimento / panelling / revestimiento

5\_ rete di ancoraggio / anchoring mesh / red de fijación

6\_ massetto / floor slab / bloque base

7\_ bacino / basin / pila

8\_ imbuto regolabile / adjustable funnel / embudo regulable

9\_ alzata composita in corian / composite riser in corian / zócalo compuesto de corian

10\_ tubo di scarico / drain pipe / tubo de desagüe

11\_ piletta sifonata (attacco a manicotto) / siphon waste (sleeve attachment) / válvula de desagüe con sifón (conexión manguito)

12\_ rete di rinforzo (acciaio) / reinforced mesh (steel) / red de refuerzo (acero)

13\_ colla Mapei Keralastic / Mapei Keralastic glue / cola Mapei/Keralastic

21\_ fix\_massetto in EPS, rivestito in corian® / EPS footboard finished in corian® / panel de EPS, revestido en corian®

22\_ silicone / silicon / silicona

# pluvio corian®

## installazione appoggio \_ floor-standing installation \_ instalación superpuesta

- 1\_ muratura / masonry / mampostería
- 2\_ intonaco / mortar / enlucido
- 3\_ colla / glue / cola
- 4\_ rivestimento / panelling / revestimiento
- 5\_ rete di ancoraggio / anchoring mesh / red de fijación
- 6\_ massetto / floor slab / bloque base
- 7\_ bacino / basin / pila
- 8\_ imbuto regolabile / adjustable funnel / embudo regulable
- 9\_ alzata composita in corian / composite riser in corian / copete compuesto de corian
- 10\_ tubo di scarico / drain pipe / tubo de desagüe
- 11\_ piletta sifonata (attacco a manicotto) / siphon waste (sleeve attachment) / válvula de desagüe con sifón (conexión manguito)
- 13\_ colla Mapei Keralastic / Mapei Keralastic glue / cola Mapei/Keralastic
- 21\_ fix\_massetto in EPS, rivestito in corian® / EPS footboard finished in corian® / panel de EPS, revestido en corian®
- 22\_ silicone / silicon / silicona

- **A-B-C** MISURE PIATTO DOCCIA DA RIVESTIRE
- **X-Y** MISURE BACINO TERMOFORMATO
- **contromuro**: bacino incassato sottointonaco 1cm
- **contromuro (cartongesso)**: bacino addossato 1ª lastra di cartongesso
- **lati liberi**: bacino in asse alzata
- tolleranza dimensionale bacino (PST) termoformato 8%

- **A-B-C** DIMENSIONS OF SHOWER TRAY TO CLAD
- **X-Y** DIMENSIONS OF THERMOFORMED BASIN
- **wall side**: basin is set 1cm into the plasterboard
- **wall side (plasterboard)**: basin attached to the first layer of plasterboard
- **free sides**: basin centered on riser
- dimensional tolerance thermoformed basin (PST) 8%

- **A-B-C** MEDIDAS PLATO DE DUCHA PARA REVESTIR
- **X-Y** MEDIDAS PILA TERMOCONFORMADA
- **contramuro**: pila encastrada bajo enlucido 1cm
- **contramuro (cartón piedra)**: pila adosada 1ª lámina de cartón piedra
- **lados libres**: pila alineada a zócalo
- tolerancia dimensional pila (PST) termoconformada 8%

### PILETTA/ WASTE/ VÁLVULA DE DESAGÜE

portata 35 l/min / capacity 35l/min / caudal 35 l/min

La verifica di portata va effettuata a pavimento finito o con imbuto installato /

The flow rate is to be checked with finished floor and funnel installed /

El control del caudal debe efectuarse con el pavimento acabado o después de instalar el embudo

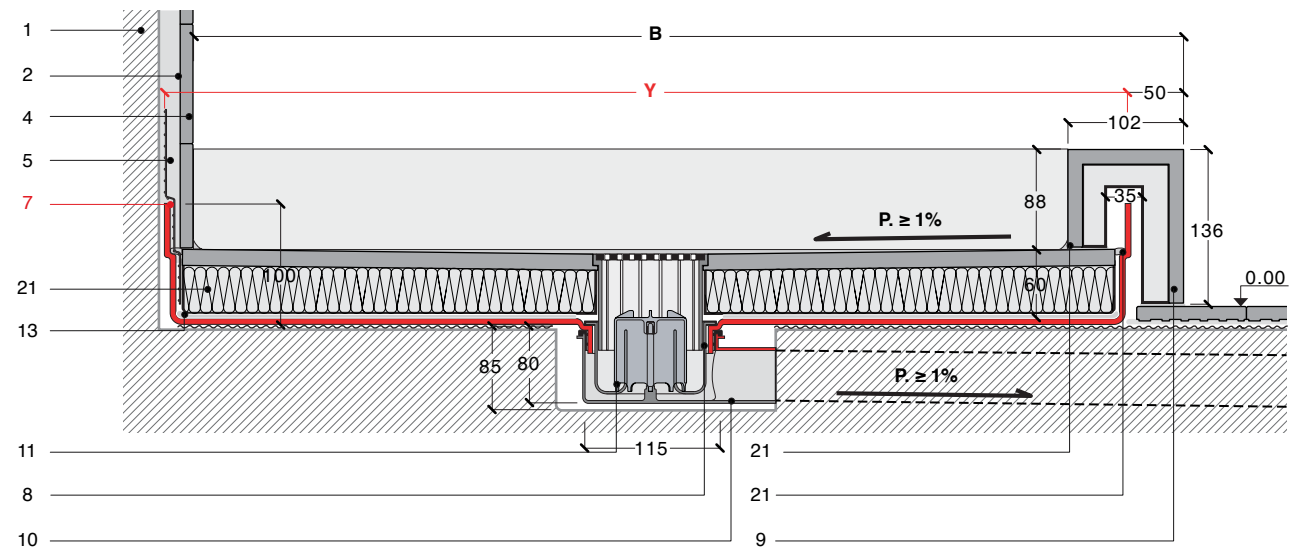
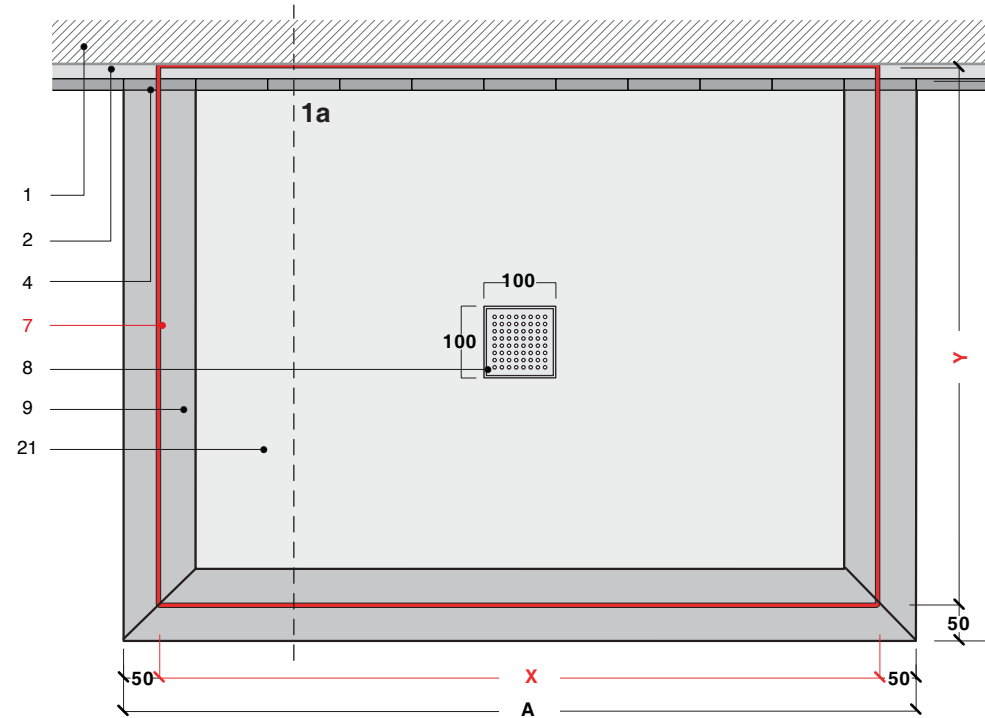

pluvio corian®

installazione filopavimento \_ floor flush installation \_ instalación a ras del suelo

kit: bacino (PST) / basin (PST) / pila (PST) - piletta sifonata (35lt/min) / siphon waste (35lt/min) / válvula de desagüe con sifón (35lt/min) - rete di ancoraggio / anchoring mesh / red de fijación - imbuto regolabile con griglia / adjustable funnel with grille / embudo regulable con rejilla

opt: alzata e pedana composite in corian / riser and footboard in corian / zócalo y tarima compuestos de corian

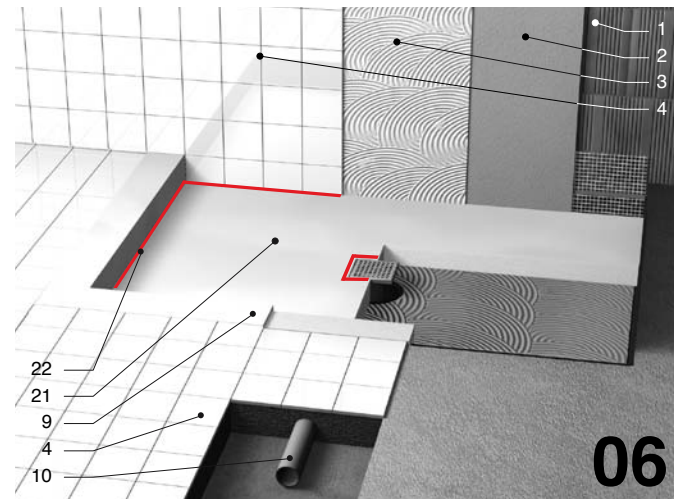
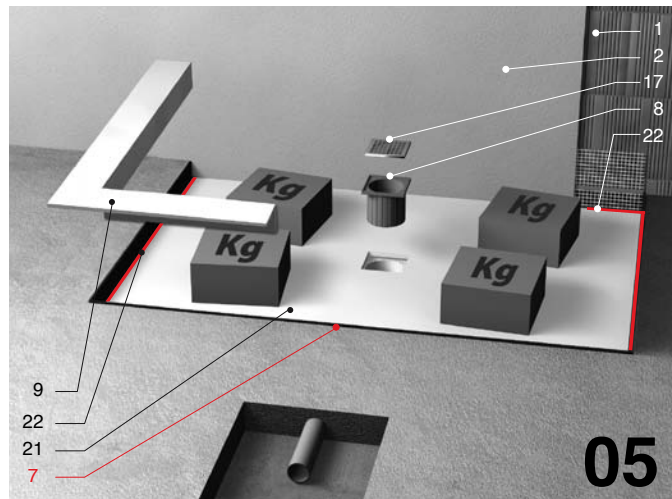
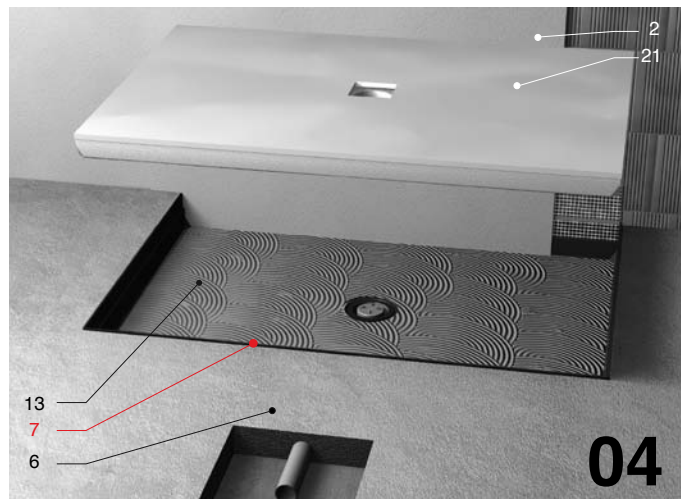
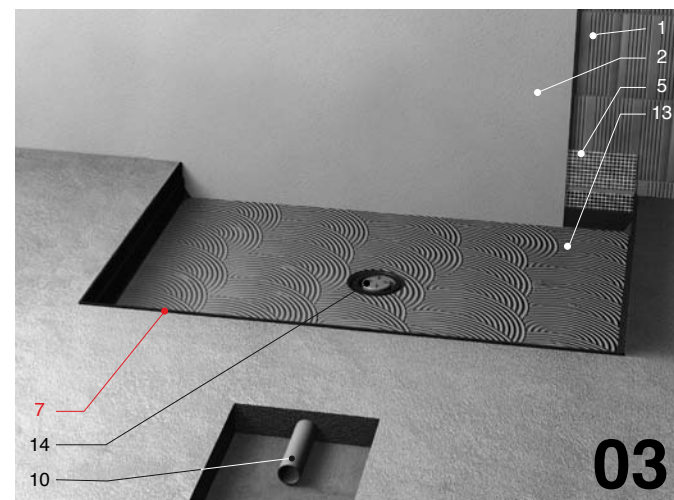
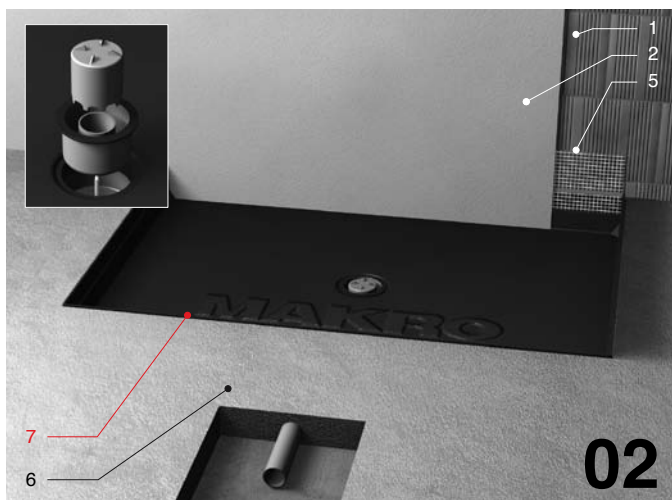
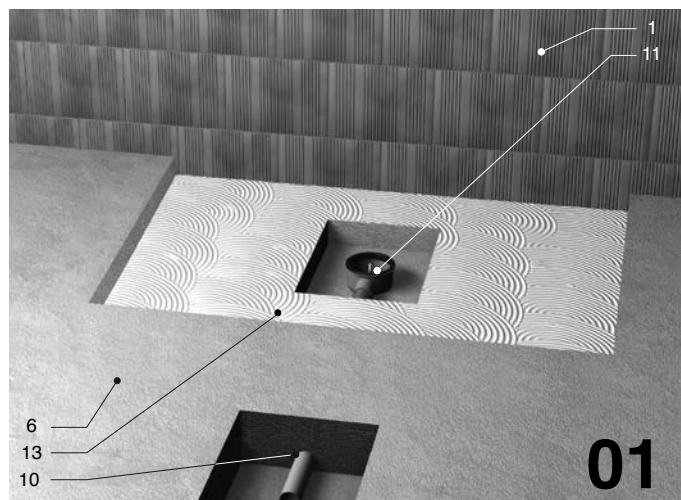

1\_ muratura / masonry / mampostería

2\_ intonaco / mortar / enlucido

3\_ colla / glue / cola

4\_ rivestimento / panelling / revestimiento

5\_ rete di ancoraggio / anchoring mesh / red de fijación

6\_ massetto / floor slab / bloque base

7\_ bacino / basin / pila

8\_ imbuto regolabile / adjustable funnel / embudo regulable

9\_ alzata composita in corian / composite riser in corian / zócalo compuesto de corian

10\_ tubo di scarico / drain pipe / tubo de desagüe

11\_ piletta sifonata (attacco a manicotto) / siphon waste (sleeve attachment) / válvula de desagüe con sifón (conexión manguito)

12\_ rete di rinforzo (acciaio) / reinforced mesh (steel) / red de refuerzo (acero)

13\_ colla Mapei Keralastic / Mapei Keralastic glue / cola Mapei/Keralastic

21\_ pedana composita in corian / composite footboard in corian / tarima compuesta de corian

22\_ silicone / silicon / silicona

# pluvio corian®

## filopavimento \_ floor flush basin \_ a ras del suelo

- 1\_ muratura / masonry / mamposteria
- 2\_ intonaco / mortar / enlucido
- 3\_ colla / glue / cola
- 4\_ rivestimento / panelling / revestimiento
- 5\_ rete di ancoraggio / anchoring mesh / red de fijación
- 6\_ massetto / floor slab / bloque base
- 7\_ bacino / basin / pila
- 8\_ imbuto regolabile / adjustable funnel / embudo regulable
- 9\_ alzata composita in corian / composite riser in corian / copete compuesto de corian
- 10\_ tubo di scarico / drain pipe / tubo de desagüe
- 11\_ piletta sifonata (attacco a manicotto) / siphon waste (sleeve attachment) / válvula de desagüe con sifón (conexión manguito)
- 13\_ colla Mapei Keralastic / Mapei Keralastic glue / cola Mapei/ Keralastic
- 21\_ fix\_massetto in EPS, rivestito in corian® / EPS footboard finished in corian® / panel de EPS, revestido en corian®
- 22\_ silicone / silicon / silicona

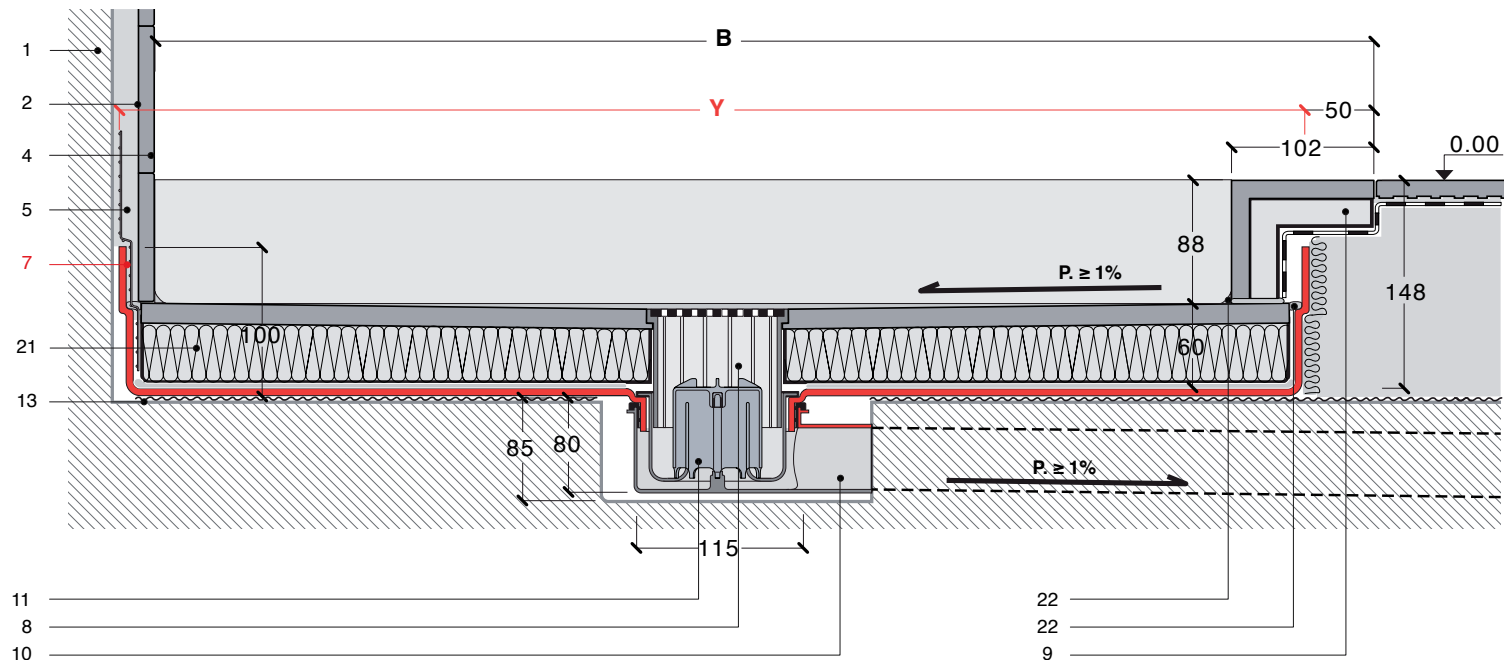

- **A-B-C** MISURE PIATTO DOCCIA
- **X-Y** MISURE BACINO TERMOFORMATO
- **contromuro**: bacino incassato sottointonaco 1cm
- **contromuro (cartongesso)**: bacino addossato 1ª lastra di cartongesso
- **lati liberi**: bacino in asse alzata
- tolleranza dimensionale bacino (PST) termoformato 8%.

- **A-B-C** DIMENSIONS OF SHOWER TRAY
- **X-Y** DIMENSIONS OF THERMOFORMED BASIN
- **wall side**: basin is set 1cm into the plasterboard
- **wall side (plasterboard)**: basin attached to the first layer of plasterboard
- **free sides**: basin centered on riser
- dimensional tolerance thermoformed basin (PST) 8%.

- **A-B-C** MEDIDAS PLATO DE DUCHA
- **X-Y** MEDIDAS PILA TERMOCONFORMADA
- **contramuro**: pila encastrada bajo enlucido 1cm
- **contramuro (cartón piedra)**: pila adosada 1ª lámina de cartón piedra
- **lados libres**: pila alineada a zócalo
- tolerancia dimensional pila (PST) termoconformada 8%.

bacino a misura / custom made basin / pila a medida

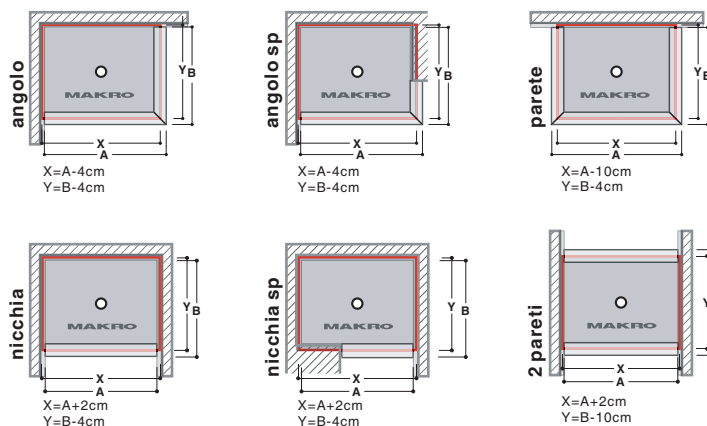

bacini speciali / special basins / pilas especiales

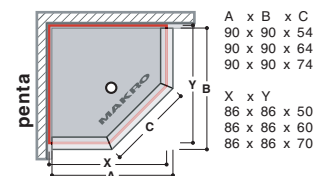

### PILETTA/ WASTE/ VÁLVULA DE DESAGÜE

portata 35 l/min / capacity 35lt/min / caudal 35 l/min

La verifica di portata va effettuata a pavimento finito o con imbuto installato / The flow rate is to be checked with finished floor and funnel installed / El control del caudal debe efectuarse con el pavimento acabado o después de instalar el embudo

## installazione semincasso \_ embedded installation \_ instalación semiencastre

kit: bacino (PST) / basin (PST) / pila (PST) - piletta sifonata (35lt/min) / siphon waste (35lt/min) / válvula de desagüe con sifón (35lt/min) - rete di ancoraggio / anchoring mesh / red de fijación - imbuto regolabile con griglia / adjustable funnel with grille / embudo regulable con rejilla

opt: alzata e pedana composite in corian / riser and footboard in corian / zócalo y tarima compuestos de corian

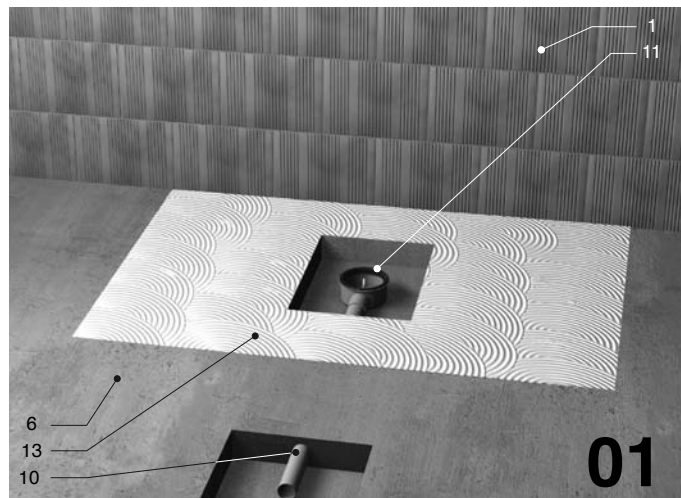

01

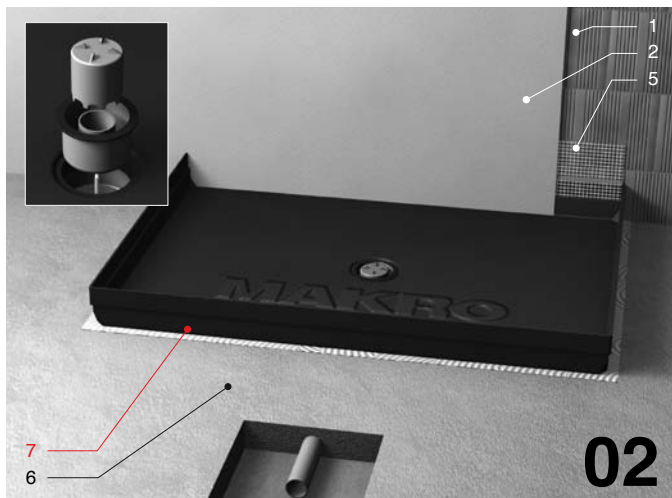

02

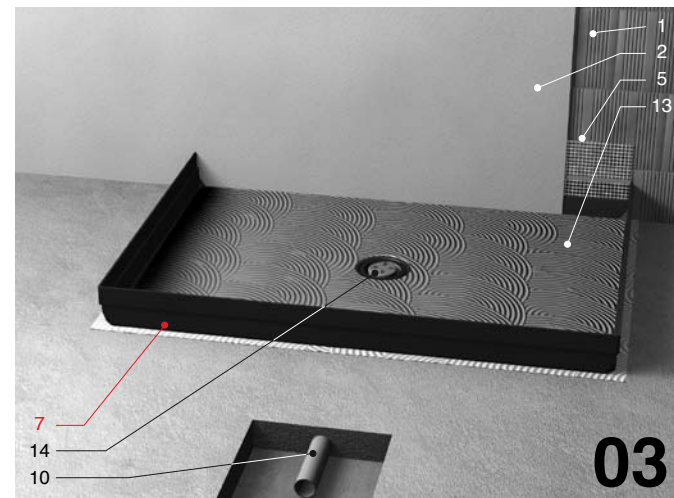

03

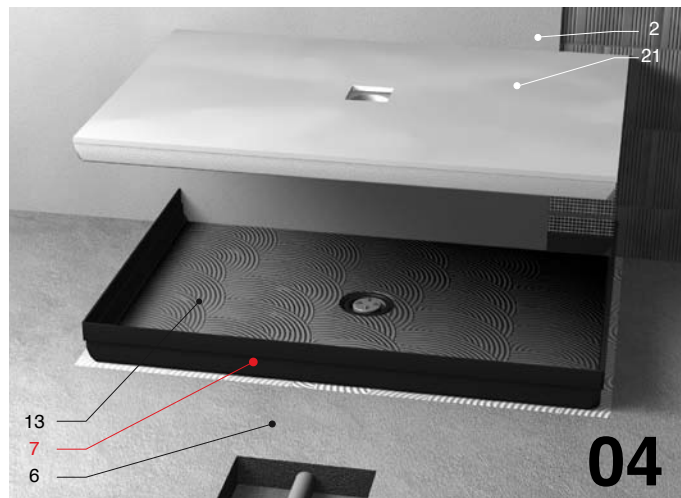

04

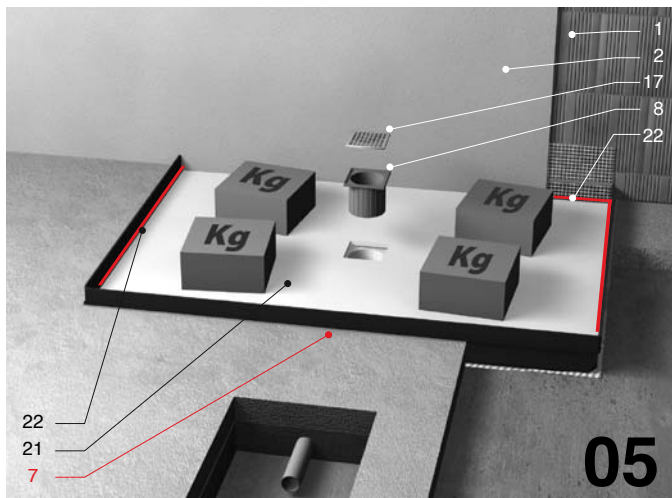

05

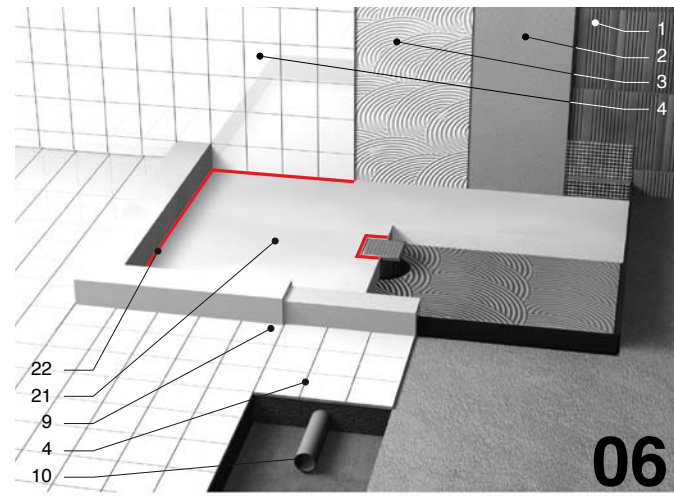

06

1\_ muratura / masonry / mampostería

2\_ intonaco / mortar / enlucido

3\_ colla / glue / cola

4\_ rivestimento / panelling / revestimiento

5\_ rete di ancoraggio / anchoring mesh / red de fijación

6\_ massetto / floor slab / bloque base

7\_ bacino / basin / pila

8\_ imbuto regolabile / adjustable funnel / embudo regulable

9\_ alzata composita in corian / composite riser in corian / zócalo compuesto de corian

10\_ tubo di scarico / drain pipe / tubo de desagüe

11\_ piletta sifonata (attacco a manicotto) / siphon waste (sleeve attachment) / válvula de desagüe con sifón (conexión manguito)

12\_ rete di rinforzo (acciaio) / reinforced mesh (steel) / red de refuerzo (acero)

13\_ colla Mapei Keralastic / Mapei Keralastic glue / cola Mapei/Keralastic

21\_ fix\_massetto in EPS, rivestito in corian® / EPS footboard finished in corian® / panel de EPS, revestido en corian®

22\_ silicone / silicon / silicona

# pluvio corian®

## installazione semincasso \_ embedded installation \_ instalación semiencastrada

- 1\_ muratura / masonry / mampostería
- 2\_ intonaco / mortar / enlucido
- 3\_ colla / glue / cola
- 4\_ rivestimento / panelling / revestimiento
- 5\_ rete di ancoraggio / anchoring mesh / red de fijación
- 6\_ massetto / floor slab / bloque base
- 7\_ bacino / basin / pila
- 8\_ imbuto regolabile / adjustable funnel / embudo regulable
- 9\_ alzata composita in corian / composite riser in corian / copete compuesto de corian
- 10\_ tubo di scarico / drain pipe / tubo de desagüe
- 11\_ piletta sifonata (attacco a manicotto) / siphon waste (sleeve attachment) / válvula de desagüe con sifón (conexión manguito)
- 13\_ colla Mapei Keralastic / Mapei Keralastic glue / cola Mapei/Keralastic
- 21\_ fix\_massetto in EPS, rivestito in corian® / EPS footboard finished in corian® / panel de EPS, revestido en corian®
- 22\_ silicone / silicon / silicona

- **A-B-C** MISURE PIATTO DOCCIA DA RIVESTIRE
- **X-Y** MISURE BACINO TERMOFORMATO
- **contromuro**: bacino incassato sottointonaco 1cm
- **contromuro (cartongesso)**: bacino addossato 1ª lastra di cartongesso
- **lati liberi**: bacino in asse alzata
- tolleranza dimensionale bacino (PST) termoformato 8‰

- **A-B-C** DIMENSIONS OF SHOWER TRAY TO CLAD
- **X-Y** DIMENSIONS OF THERMOFORMED BASIN
- **wall side**: basin is set 1cm into the plasterboard
- **wall side (plasterboard)**: basin attached to the first layer of plasterboard
- **free sides**: basin centered on riser
- dimensional tolerance thermoformed basin (PST) 8‰

- **A-B-C** MEDIDAS PLATO DE DUCHA PARA REVESTIR
- **X-Y** MEDIDAS PILA TERMOCONFORMADA
- **contramuro**: pila encastrada bajo enlucido 1cm
- **contramuro (cartón piedra)**: pila adosada 1ª lámina de cartón piedra
- **lados libres**: pila alineada a zócalo
- tolerancia dimensional pila (PST) termoconformada 8‰

### PILETTA/ WASTE/ VÁLVULA DE DESAGÜE

portata 35 l/min / capacity 35lt/min / caudal 35 l/min

La verifica di portata va effettuata a pavimento finito o con imbuto installato /

The flow rate is to be checked with finished floor and funnel installed /

El control del caudal debe efectuarse con el pavimento acabado o después de instalar el embudo

